

# Shenzhen Kunteng Co.ltd

## Technical Data Sheet

### CR1632

- 1 Chemical System: Lithium/Manganese Dioxide(Li/MnO<sub>2</sub>)
- 2 Nominal Voltage: 3.0V
- 3 Nominal capacity: 120mAh(rated at 30KΩ continuous at 20±3<sup>0</sup>C to 2.0V)
- 4 Average weight: 2.3g
- 5 Dimensions

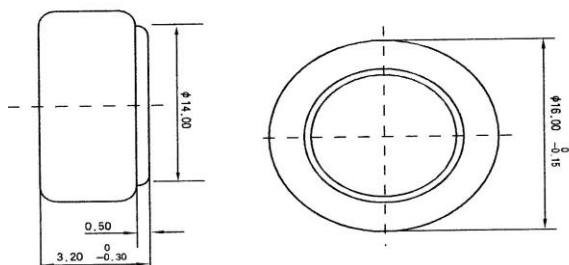

- 6 Performance: refer to below table:

#### 6.1 Electrical parameters

Item	Storage	Performance	Test condition
OCV	fresh	3.20V~3.40V	DC Voltmeter: accuracy ≥ ±0.005V input impedance ≥ 1MΩ
	after 12 months	3.00V~3.20V	
CCV	fresh	≥ 3.00V	DC voltmeter: same as above load: 30KΩ for 0.8 sec.
	after 12 months	≥ 3.00V	

#### 6.2 Service life

Item	Storage	Performance	Test condition
Rated at 30KΩ	Fresh	≥ 1275hrs	load: 30KΩ, cutoff voltage: 2.0V
	after 12 months	≥ 1150hrs	

#### 6.3 Leakage proof

Leakage upon overdischarge :  
Deformations should not exceed by 0.2mm over the maximum

dimensions. No leakage shall take place.

#### Test condition:

temperature: 20±3<sup>0</sup>C

humidity: (65±10)%RH

load: 30KΩ

overdischarge: 48hrs

(further discharge upon cut off as specified)

- 7 Typical discharge curve

load: 30KΩ

cutoff voltage:2.0V

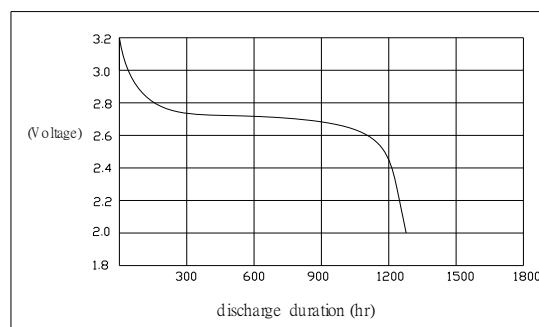

- 8 Marking:

- 8.1 model number: CR1632
- 8.2 brand: "TINKO", "Neutral"
- 8.3 polarity: "+" marking on positive terminal (no "-" marking)
- 8.4 other specified marking:

- 9 Precautions:

- 9.1 Never charge the battery as it is not designed to be rechargeable, may cause leakage or damage to device.
- 9.2 Insert battery with its positive and negative terminals properly aligned with the corresponding marks on the equipment.
- 9.3 Never short circuit, heat, incinerate or disassemble the battery.

- 10 Warranty : 24 months after delivery