

## AGM DEEP CYCLE BATTERY

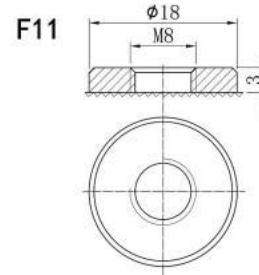

Model: BT-65-12 (12V65AH)



### Application

- ☆ Security systems
- ☆ UPS power supply
- ☆ Emergency Power Supply
- ☆ Telecom Equipment
- ☆ Power station

### General Features

- ☆ Designed floating charging service life: 12years (25°C)
- ☆ Sealed and maintenance free operation
- ☆ Safety valve installation for explosion proof
- ☆ Low self-discharge characteristic
- ☆ Wide operating temperature range from 0°C-40°C
- ☆ Lead Calcium Aluminum Tin alloy high energy, prevent corrosion

PHYSICAL SPECIFICATIONS		
<b>Nominal Voltage</b>		12V
<b>Nominal Capacity (10HR)</b>		65AH
<b>Dimensions</b>	<b>Length</b>	350±.3mm
	<b>Width</b>	167±2mm
	<b>Container height</b>	173±2mm
	<b>Total Height (with terminal)</b>	173±2mm
<b>Weight±3%</b>		Approx 19.20Kg(43.33lbs)
<b>Internal Resistance(In full charge status)</b>		≈5.50mΩ
<b>Standard Terminals</b>		F11(standard)

Constant – Voltage Charge	
<b>Cycle application</b>	<ol style="list-style-type: none"> <li>1. Limit initial current less than 16.25A.</li> <li>2. Charge until battery voltage (under charge) reaches 14.1V to 14.4V at 25°C (77F) .</li> <li>3. Hold at 14.1V to 14.4V until current drop to under 0.39A for at least 3 hours.</li> <li>4. Temperature compensation coefficient of charging voltage is -30mV/°C.</li> </ol>
<b>Standby service</b>	<ol style="list-style-type: none"> <li>1. Hold battery across constant voltage source of 13.6to 13.8 volts with current limit 16.25A continuously .When held at this voltage , the battery will seek its own current level and maintain itself in a fully charge status.</li> <li>2. Temperature compensation coefficient of charging voltage is -18mV/°C</li> </ol>
<p>NOTE : The battery should be charged within 6 months of storage ,Otherwise , permanent loss of capacity might occur as a result of sulfation</p>	

## Charge Characteristics

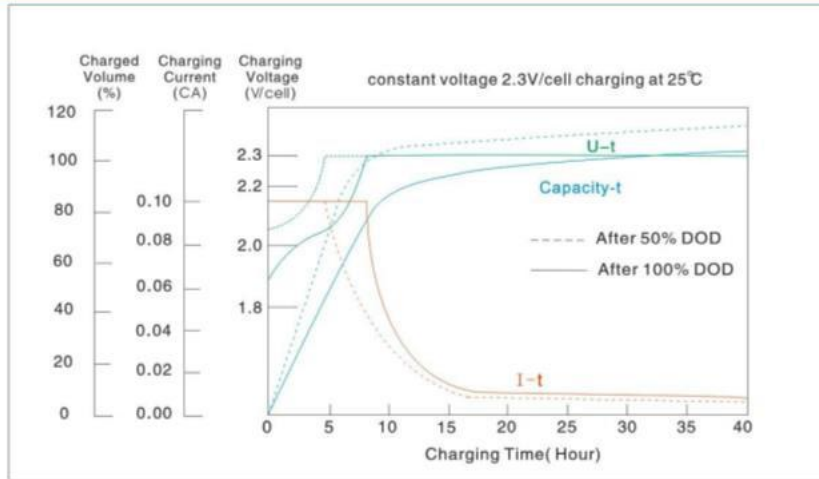

## Discharge Current & Discharge Duration Time (25°C/77°F)

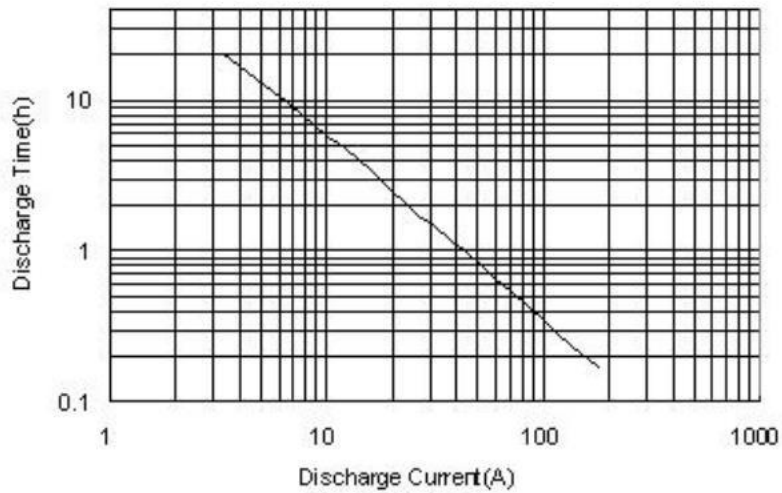

## Discharge Characteristic (25°C/77°F)

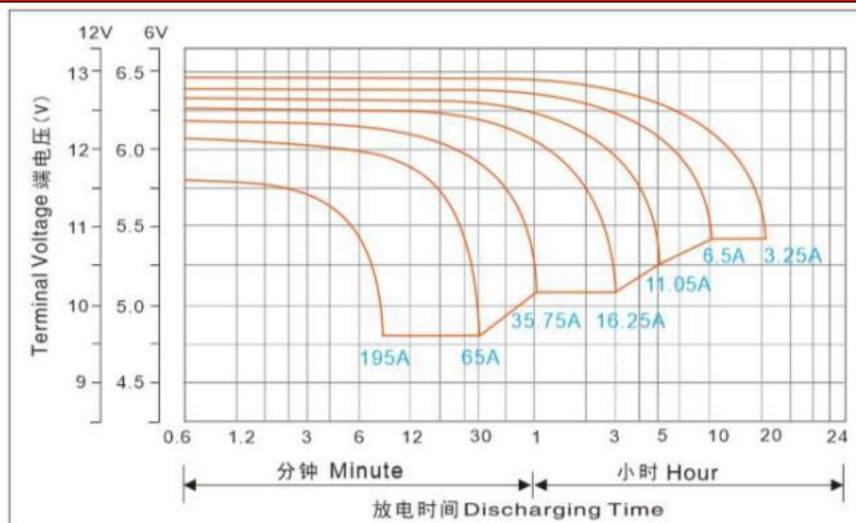

ELECTRICAL SPECIFICATIONS		
<b>Rated Capacity</b>	20 hour rate(3.25A)	67.50AH
	10 hour rate(6.50A)	65.00AH
	5 hour rate(11.05A)	55.30AH
	3 hour rate(16.25A)	49.00AH
	1 hour rate (35.75A)	36.20AH
<b>Capacity affected by Temperature (10Hour Rate)</b>	40°C(104°F)	103%
	25°C(77°F)	100%
	0°C(32°F)	86%

Constant Current Discharge Data Sheet ( Amperes at 25°C)													
End Voltage	Minute (M)					Hour (H)							
	5	10	15	30	45	1	1.5	2	3	5	8	10	20
10.20	205	156	118	62.3	57.9	40.6	32.1	26.8	16.83	11.69	8.32	6.95	3.55
10.50	182	143	110	59.8	55.3	39.0	30.8	25.8	16.29	11.17	7.87	6.70	3.52
10.80	169	130	103	57.8	52.7	37.4	29.6	24.8	15.72	10.6	7.48	6.58	3.48

Constant Power Discharge Data Sheet ( Watt at 25°C)													
End Voltage	Minute (M)					Hour (H)							
	5	10	15	30	45	1	1.5	2	3	5	8	10	20
10.20	2035	1723	1251	779	585	508	371	279	208	134	99.5	84.5	44.3
10.50	1957	1463	1123	761	572	501	365	270	201	130	98.2	81.9	42.9
10.80	1820	1365	1072	744	553	478	348	261	194	125	96.9	78.0	41.9

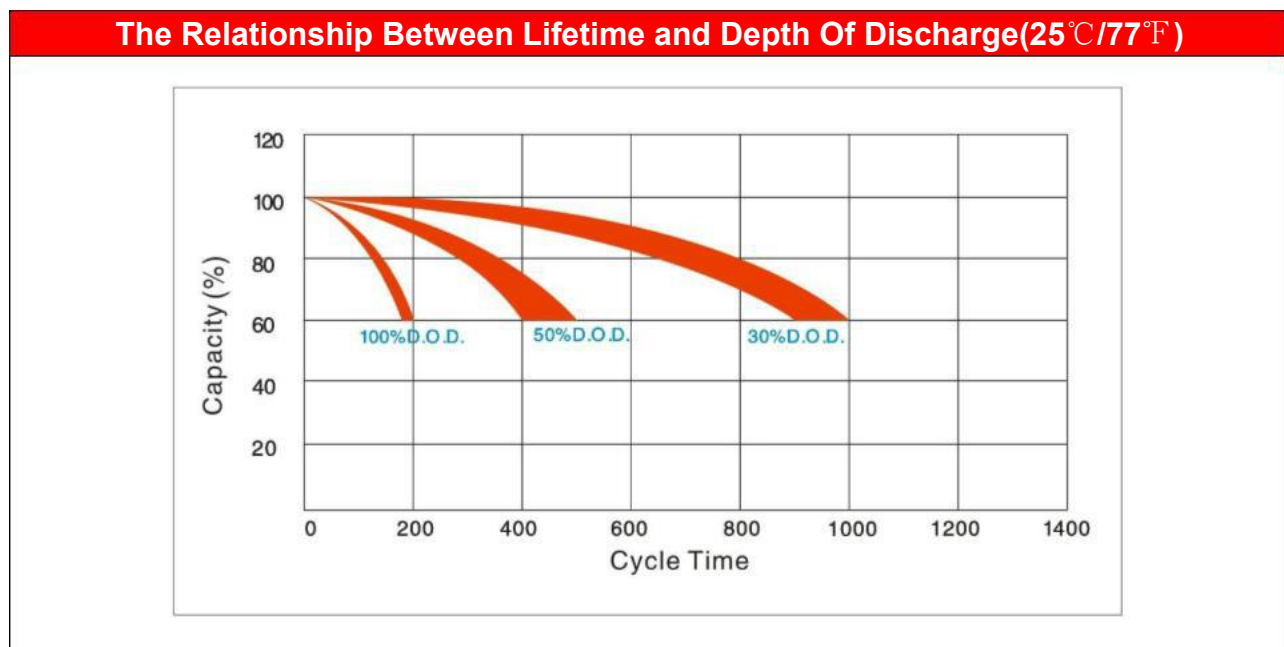

### Capacity Curve at Different Temperature

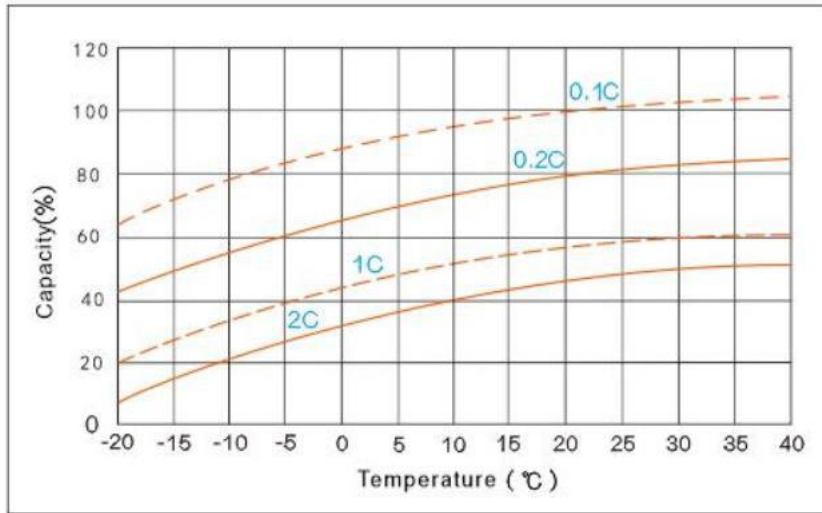

### Storage Characteristics

