

- P.C.B. or plug-in mount
- AC, DC, sensitive DC or single bistable coil versions available
- 8 mm, 6 kV (1.2/50  $\mu$ s) between coil and contacts
- Ambient temperature + 85 °C
- RT III (wash tight) version available
- Sockets and accessories: see 95, 99 and 86 series

\* For 400 V applications, where requirements for pollution degree 2 are met.

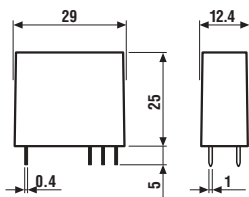

### 40.31

### 40.51

### 40.52



- 1 pole, 10 A
- 3.5 mm pinning
- P.C.B./for use with 95 series sockets

- 1 pole, 10 A
- 5 mm pinning
- P.C.B./for use with 95 series sockets

- 2 pole, 8 A
- 5 mm pinning
- P.C.B./for use with 95 series sockets

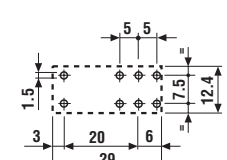
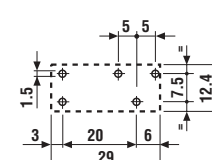
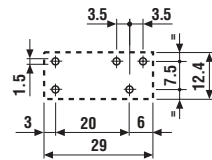
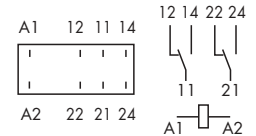
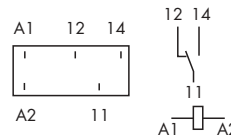
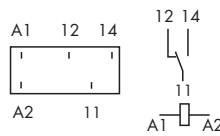

Copper side view

Copper side view

Copper side view

Contact specifications				
Contact configuration		1 CO (SPDT)	1 CO (SPDT)	2 CO (DPDT)
Rated current/Maximum peak current	A	10/20	10/20	8/15
Rated voltage/Maximum switching voltage V AC		250/400*	250/400*	250/250
Rated load in AC1	VA	2,500	2,500	2,000
Rated load in AC15 (230 V AC)	VA	500	500	400
Single phase motor rating (230 V AC)	kW	0.37	0.37	0.3
Breaking capacity in DC1: 30/110/220 V	A	10/0.3/0.12	10/0.3/0.12	8/0.3/0.12
Minimum switching load	mW (V/mA)	300 (5/5)	300 (5/5)	300 (5/5)
Standard contact material		AgNi	AgNi	AgNi
Coil specifications				
Nominal voltage (U <sub>N</sub> )	V AC (50/60 Hz)	6 - 12 - 24 - 48 - 60 - 110 - 120 - 230 - 240		
	V DC	5 - 6 - 7 - 9 - 12 - 14 - 18 - 21 - 24 - 28 - 36 - 48 - 60 - 90 - 110 - 125		
Rated power AC/DC/sens. DC	VA [50 Hz]/W/W	1.2/0.65/0.5	1.2/0.65/0.5	1.2/0.65/0.5
Operating range	AC	(0.8...1.1)U <sub>N</sub>		
	DC/sens. DC	(0.73...1.5)U <sub>N</sub> / (0.73...1.75)U <sub>N</sub>		
Holding voltage	AC/DC	0.8 U <sub>N</sub> / 0.4 U <sub>N</sub>		
Must drop-out voltage	AC/DC	0.2 U <sub>N</sub> / 0.1 U <sub>N</sub>		
Technical data				
Mechanical life AC/DC	cycles	10 · 10 <sup>6</sup> / 20 · 10 <sup>6</sup>		
Electrical life at rated load AC1	cycles	200 · 10 <sup>3</sup>		
Operate/release time	ms	7/3 - (12/4 sensitive)		
Insulation according to EN 61810-1 ed. 2		4 kV/3		
Insulation between coil and contacts (1.2/50 $\mu$ s)	kV	6 (8 mm)		
Dielectric strength between open contacts	V AC	1,000		
Ambient temperature range	°C	-40...+85		
Environmental protection		RT II**		

Approvals (according to type):



\*\* See page 202 "Guidelines for automatic flow solder processes".